

Two Bedroom with Downtown Skyline and Canal Views

AED 3,700,000

Ref: S-1068

**DG1, Downtown & Burj Khalifa District,
Dubai**



Field Type: For Sale



Property Status: Available



Property Type: Apartment



Number of Bedrooms: 2



Number of Bathrooms: 3



Area: 1631 sq ft



TEREZAESTATES.COM

BUY | SELL | RENT

Gallery

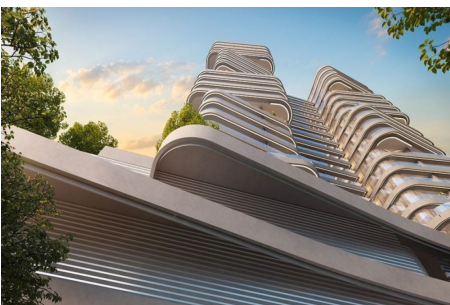
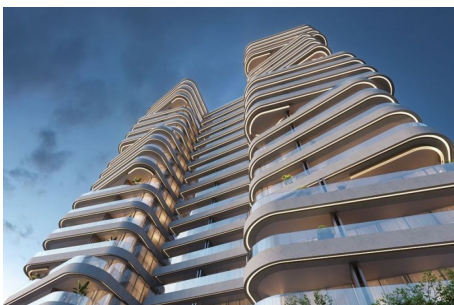
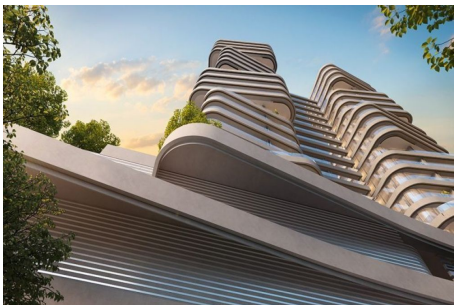
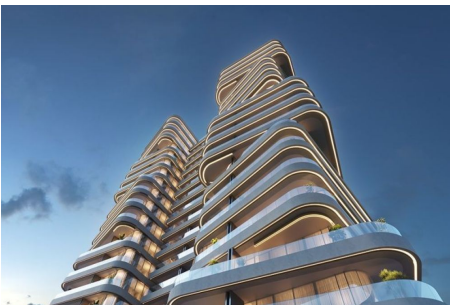

TEREZAESTATES.COM
BUY | SELL | RENT

Property Description

Location: DG1, Downtown & Burj Khalifa District, Dubai

Tereza Estates present this Two Bedroom with Downtown Skyline and Business Bay Canal Views for sale in DG1 - a luxury residential development located in the heart of Business Bay, Dubai conveniently situated on the Business Bay canal with its long promenade where you can enjoy your daily walks, cycling or running while admiring the Dubai's impressive architecture. This luxury new development in Dubai features unique elegant aesthetics with a futuristic architecture feel. Apartments are ranging from one , two and three bedroom apartments.

The apartments at DG1 Living are spacious and finished to exceptional quality the developer takes pride in. They feature high ceilings, large windows, and modern, elegant finishes. The kitchens are fully equipped with stainless steel appliances, and the bathrooms have marble countertops and bathtubs as well as walkin showers. The development also offers a wide range of amenities, including a swimming pool, gym & spa, wonderful rooftop sky garden, and a business center for those who love to embrace work from home lifestyle yet still like to socialize with other residents of the building. There is also a 24/7-hour security team on duty to ensure the safety of residents of course and reception to assist guests with their queries.

DG1 Living is a great choice for those who want to live in a luxurious, convenient location in Dubai and for those who want to be in the heart of the action, which Burj Khalifa District, Downtown & Business Bay undeniably is. This modern luxury development is within walking distance of the largest shopping mall in the world - The Dubai Mall and of course the iconic Burj Khalifa. There are also a number of restaurants, bars, and shops within the development itself providing residents easy access to a variety of retail spaces and cafes at the convenience of your residence.

Estimated Completion : Q1 2027

Trakheesi Permit #1773073980

If you would like to know more about this apartment in DG1 Living Business Bay, please contact us on **+971585365111** or fill an inquiry form with your details to request a call back.



TEREZAESTATES.COM

BUY | SELL | RENT

Additional Info

For Sale	Floor Area : 1631 sq ft	Elegant Interiors
Rooftop Sky Garden	Water Views	Landmark Views
On the Business Bay Canal	Close to Downtown Dubai	Close to The Dubai Mall
Close to the Burj Khalifa		

Amenities

Gym & Spa	Infinity swimming pool	Landscaped Podium
24/7 Security	Welcome Lobby Area	Rooftop Sky Garden
Yoga Studio	Cafes & Restaurants	



TEREZAESTATES.COM

BUY | SELL | RENT

Mobile: **+971 585 365 111**

Email: hello@terezaestates.com

TEREZA REAL ESTATE LLC

ORN: 32523, BRN: 35616

Dubai, United Arab Emirates

<https://www.terezaestates.com/public>