

Penthouse With Private Swimming Pool Burj Al Arab & Sea Views

Price on Application

Ref: S-700

Ocean House, Palm Jumeirah, Dubai

-  Field Type: For Sale
-  Property Status: Price on Application
-  Property Type: Penthouse
-  Number of Bedrooms: 5
-  Number of Bathrooms: 6
-  Area: 14036 sq ft



TEREZAESTATES.COM

BUY | SELL | RENT

Gallery

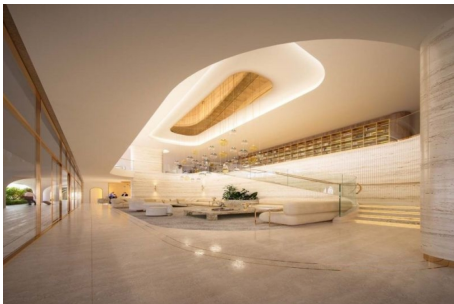

TEREZAESTATES.COM
BUY | SELL | RENT

Property Description

Location: Ocean House, Palm Jumeirah, Dubai

Tereza Estates is pleased to present this Exceptional Penthouse with Spectacular Sea & Burj Al Arab Views with your very own private swimming pool in The Ocean House, situated on the East Crescent of Palm Jumeirah.

Ocean House by Ellington has a unique architectural concept providing optimized views from all angles referred to as dual views where you can enjoy open sea views overlooking the sunset side, as well as Palm Jumeirah sea views.

This beautifully designed five bedroom penthouse spreads over a full floor size of 14036 sq.ft., featuring surrounding indoor-outdoor terrace throughout the entire penthouse suite with 5952 sq.ft. of internal area and 8083 sq.ft. of blissful outdoor space where you can enjoy truly breathtaking 360 views of all beauties of Dubai including Burj Al Arab and Downtown Dubai Skyline, as well as Marina Skyline and The Royal Atlantis, The Fronds and endless sea views from all aspects.

Private lift lobby access to welcome you back home in privacy, massive family living and dining as well as formal living and dining overlooking The Burj Al Arab and your private swimming pool at the expansive terrace space that also has its own outdoor kitchen and dining area to entertain your guests in style in a beautifully landscaped resort like residence.

Includes prep kitchen and show kitchen, both equipped with kitchen appliances by Miele, Quartz countertops, as well as staff's quarter.

Massive master suite area that includes lounge and study and four fully ensuite secondary bedrooms. Finishes will include natural marble stone flooring all throughout the living, dining and bedroom areas, with all of the five bedrooms being ensuite. Master bathroom includes his and hers sink, freestanding bathtub overlooking The Burj Al Arab along with walk-in rain-shower, sanitary ware and accessories to be all by Gessi, Geberit, Laufen or equivalent European grade with warm bronze touches. All of the bathrooms will be delivered fitted with bespoke medicine cabinets with integrated lighting and under sink storage, with soft closure finishes, and a warm subtle palette of colors in materials.

Wall and Ceiling paint all throughout to be Benjamin Moore or equivalent with matt finishes.

Meeting rooms, coworking spaces, state of the art gym, yoga room, spa treatment rooms, landscaped common areas with infinity swimming pool and beach access along with grand welcome Lobby with concierge services for restaurant bookings and other arrangements as well as valet parking services for residents and its visitors, Ocean House is truly a wonderful choice to go for when thinking of new residence at possibly the best address in the world - The Palm Jumeirah, Dubai.

Trakheesi Permit #0110865487

Estimated Completion Date: Q4 2025



TEREZAESTATES.COM

BUY | SELL | RENT

Additional Info

For Sale	Floor Area : 14036 sq ft	Partly furnished
Built in Wardrobes	Children's Play Area	Covered Parking
Maid Service	Pets Allowed	Private Gym
Security	Shared Pool	Study
View of Water	Balcony	Central A/C
Concierge	Kitchen Appliances	Maids Room
Private Garden	Private Pool	Shared Gym
Shared Spa		

Amenities